

## SYSTEM 12: Huge Bass... No holds barred performance.

This system has it all... incredible bass capability and superior sound quality. XR650-CS front components and XR525-CX rear coaxials ensure excellent spectral balance and linearity. A 300/4 delivers 300 watts to the four corners for solid dynamics and clear reproduction.

The 500/1 monoblock is dedicated to the HO212R-W3... a devastating combination. This system is shown connected to a single pair of line level outputs at the head unit. In this configuration, front-to-rear fading and subwoofer level are not adjustable from the front and must be carefully preset. The system can be set up for full fading and sub-level control with an appropriate head unit that offers these capabilities.

Add an optional RBC-I for remote control of the 500/1's EQ boost, too!

## Recommended initial amplifier settings for this system...

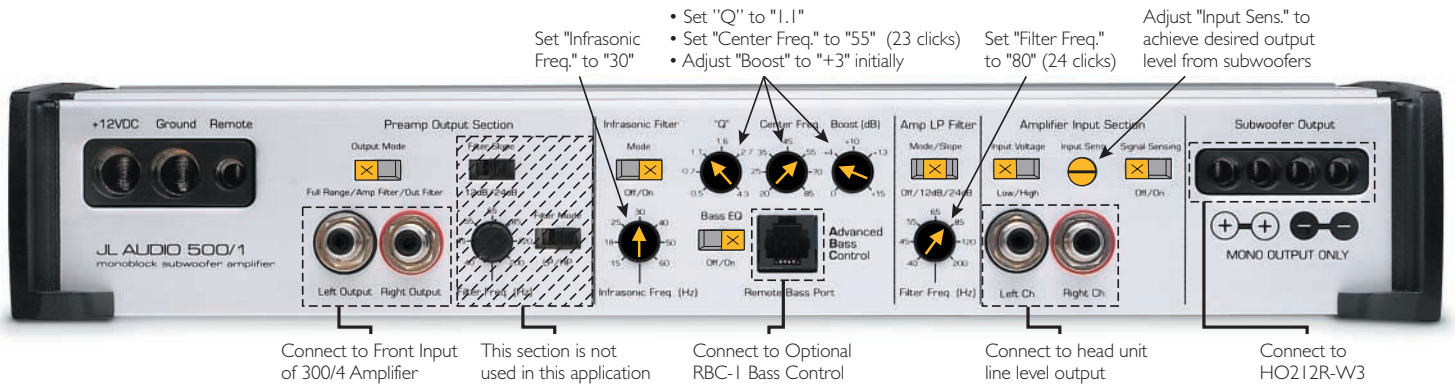

☑ ☒ ⚙ = POSITION

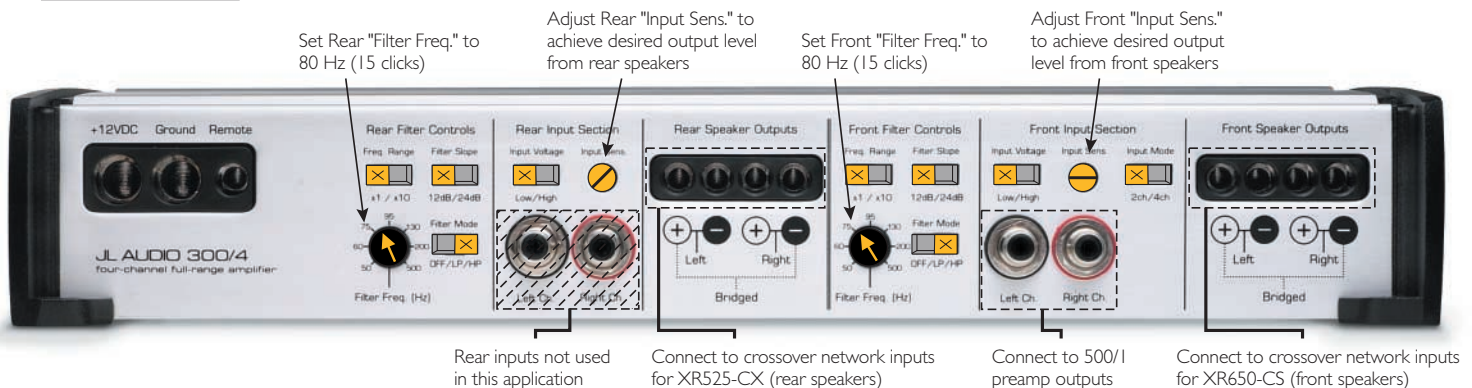

**Note:** These settings are intended as a "baseline" for tuning this system. Depending on the vehicle and the customer's tastes, some variation in the crossover and bass control settings may be necessary for optimum performance.